

**LOWER FLOOR**  
**1496 SQ. FT.**  
 7-6' CEILING HEIGHT

**MAIN FLOOR**  
**1496 SQ. FT.**  
 8'- CEILING HEIGHT

**NORTH**

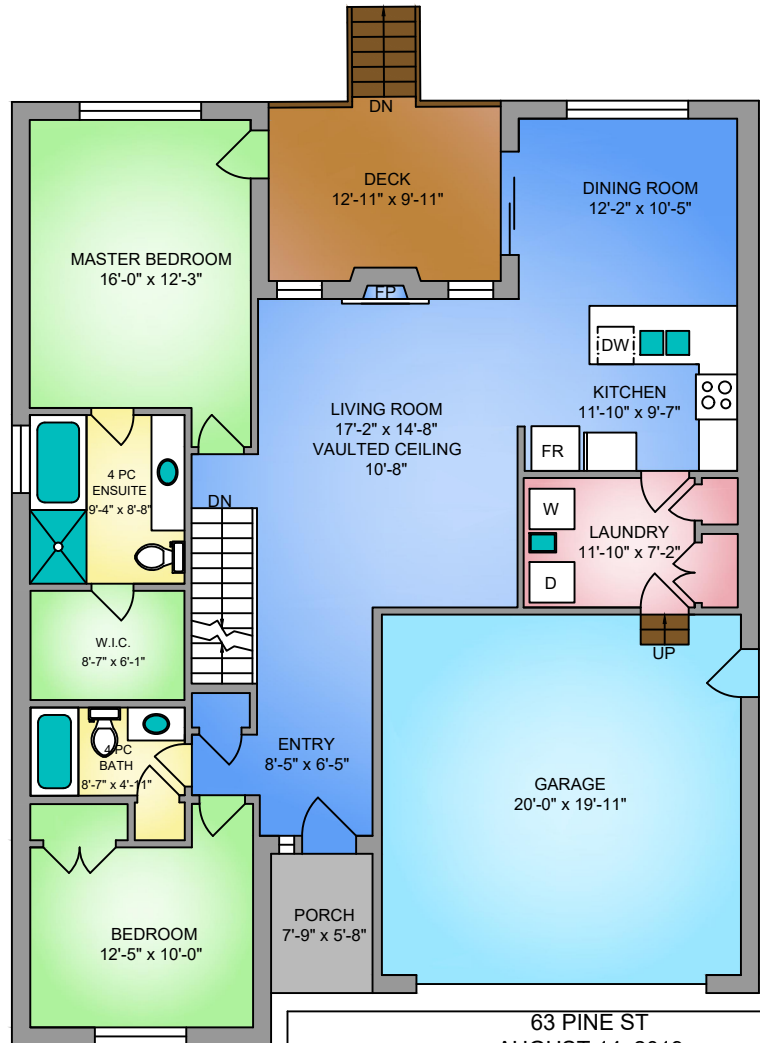
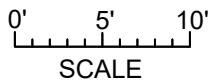
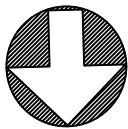

63 PINE ST  
 AUGUST 14, 2019  
 PREPARED FOR THE EXCLUSIVE USE OF THE B & B TEAM  
 PLANS MAY NOT BE 100% ACCURATE, IF CRITICAL BUYER TO VERIFY.

FLOOR	AREA (SQ. FT.)			
	FINISHED	UNFINISHED	GARAGE	DECK / PATIO
MAIN	1496	-	452	168
LOWER	-	1496	-	-
<b>TOTAL</b>	<b>1496</b>	<b>1496</b>	<b>452</b>	<b>168</b>